

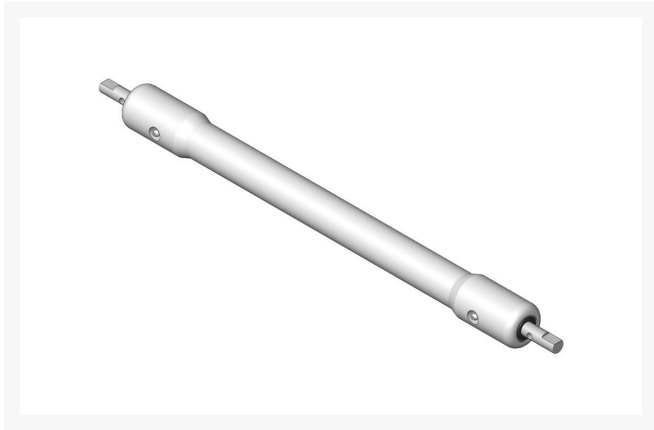

# Roller - Swaged Machined Aluminum

## R101122



### Details

Constructed with "water-pump" style bearings, this steel tubular roller contacts the ground only on the outer 2-7/8" of the roller.

### Specifications

Manufacturer	R&R Products
Roller Body	2 in
Diameter	
Weight (lbs)	4 lb

### Fits Models

Jacobsen Eclipse 122F  
Jacobsen E-Plex  
Jacobsen E-Plex II  
Jacobsen Greens King II  
Jacobsen Greens King IV  
Jacobsen Greens King V & VI  
Jacobsen G-Plex III  
Jacobsen PGM 19  
Jacobsen PGM 22

### Replacement Parts

R21-8430	Bearing - Roller
R302-5	Fitting - Grease

**Evergreen**

C/. Bartomeu Amat, 2, Entlo 1 Terrassa, 08225  
+34 931 130 054

<https://evergreen.rrproducts.com/>