

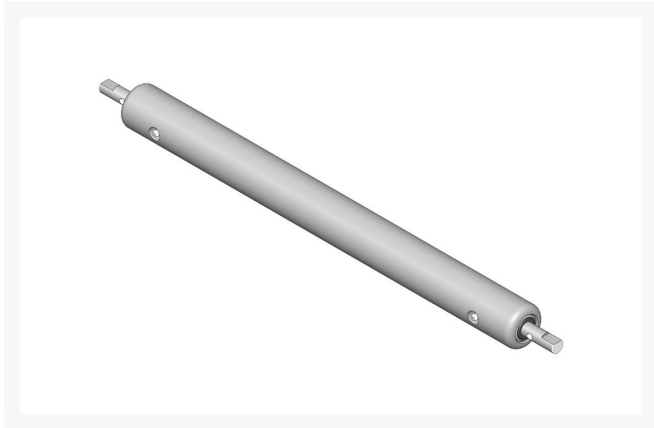

Roller - Smooth Solid Steel

R150300



Details

Machined from solid steel, this heavy weight roller uses greasable "water-pump" style bearings.

Replaces

Toro	150300
------	--------

Specifications

Manufacturer	R&R Products
Roller Body	2 in
Diameter	
Weight (lbs)	19 lb

Fits Models

- R&R Products Greens Max 2200LP
- R&R Products Versa-Green 1860
- R&R Products Versa-Green 1860PS
- Toro Greensmaster 3
- Toro Greensmaster 300
- Toro Greensmaster 3000
- Toro Greensmaster 3050
- Toro Greensmaster 3100
- Toro Greensmaster 3150-Q

Replacement Parts

R21-8430	Bearing - Roller
R302-5	Fitting - Grease

Evergreen

C/. Bartomeu Amat, 2, Entlo 1 Terrassa, 08225
+34 931 130 054

<https://evergreen.rrproducts.com/>