

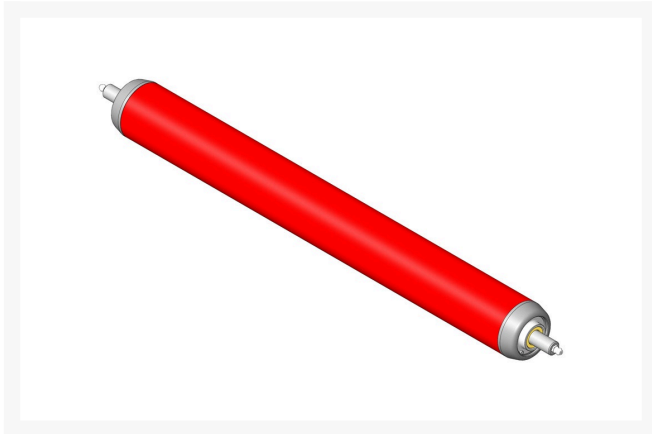

Roller - Smooth Tubular Steel

R107-4040



Details

Constructed with a through shaft, this heavy-duty roller uses greasable ball bearings. (2006 - 2007)

Replaces

R&R Products	107-4040
Toro	107-4040

Specifications

Manufacturer	R&R Products
Overhaul Kit No.	R106-9606
Roller Body	2.5 in
Diameter	
Weight (lbs)	13.5 lb

Fits Models

R&R Products Reel Max 544D
Toro Reelmaster 5210-D
Toro Reelmaster 5410-D
Toro Reelmaster 5410G
Toro Reelmaster 5510-D
Toro Reelmaster 5510-G
Toro Reelmaster 5610-D
Toro Reelmaster 6500D
Toro Reelmaster 6700D

Replacement Parts

R106-9606	Overhaul Kit - Roller
R107-3296	Shaft - Rear Long Roller
R93-3007	Seal
R343667	Bearing - Ball
R93-1251	Seal
R93-1252	Seal - Outer

Evergreen

C/. Bartomeu Amat, 2, Entlo 1 Terrassa, 08225
+34 931 130 054

<https://evergreen.rrproducts.com/>



Roller - Smooth Tubular Steel

R107-4040



R253-70	Seal
R93-2931	Washer - Roller Seal
R32120-62	Ring - Retaining
R302-5	Fitting - Grease

Evergreen

C/. Bartomeu Amat, 2, Entlo 1 Terrassa, 08225
+34 931 130 054

<https://evergreen.rrproducts.com/>