

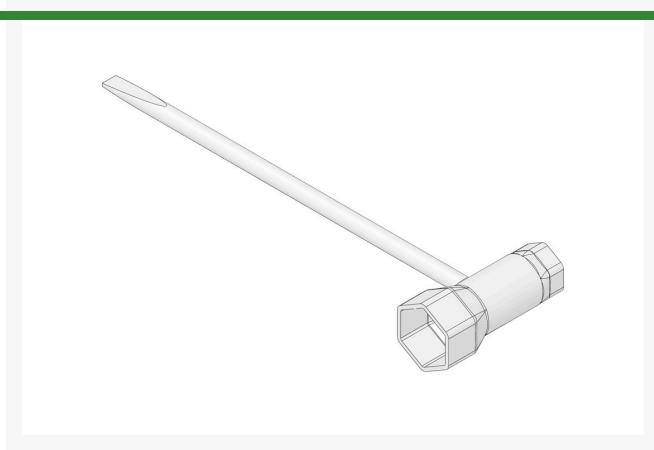

Scrench Chainsaw Tool Wrench

R57-005



Details

This 13mm x 19mm ((1/2 in. x 3/4 in.) Scrench tool is used for adjusting the chain tension on a chain saw, removing the spark plug and even accessing air filters and starters on many saws. The Scrench does the job of two wrenches and a screwdriver. It also works on many small gas engines and powered string trimmers and leaf blowers. Barrel Size 13x19mm (1/2 x 3/4 in.)

Specifications

Manufacturer	R&R Products
Dimensions	13mm x 19mm

Evergreen

C/. Bartomeu Amat, 2, Entlo 1 Terrassa, 08225
+34 931 130 054

<https://evergreen.rrproducts.com/>